

OUVERT DU 26/03 AU 29/10

TARIFS 2017



UN CAMPING ZEN & CHIC UNIQUE À RAMATUELLE

NOS LOCATIFS

OUR ACCOMMODATION

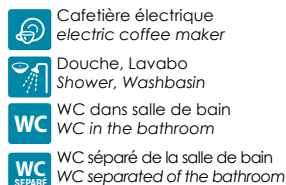

Animaux acceptés en location et emplacement (6€/ nuit et par animal). *Animals accepted in rental and location (6€/ night and per animal)*

Taxe de séjour: 0,66€/ jour/ personne de plus de 18 ans. *Tourist tax: €0,66/ day/ person 18 and over.*

Tarifs par nuit en euros / Rates per night in euros:



COTTAGE BLUE LAGON 1 - 2/3 - 1 - 1 - 19m²

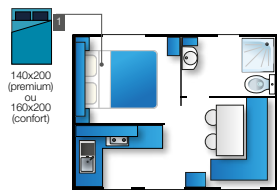

Ancienneté du locatif
5 ans



X 2

GAMME CONFORT

(TV + 1 accès WiFi + coffre-fort / TV + 1 WiFi access + safe security)

26/03	28/04	08/05	25/05	05/06	01/07	08/07	15/07	22/07	28/07	12/08	19/08	26/08	03/09	18/09	02/10
27/04	07/05	24/05	04/06	30/06	07/07	14/07	21/07	28/07	11/08	18/08	25/08	02/09	17/09	01/10	29/10
65€	90€	42€	95€	85€	115€	135€	150€	160€	166€	163€	140€	112€	80€	56€	53€

GAMME PREMIUM

(gamme confort + climatisation / Air conditioner)

72€	100€	57€	110€	97€	141€	165€	178€	183€	196€	193€	161€	129€	88€	67€	63€
-----	------	-----	------	-----	------	------	------	------	------	------	------	------	-----	-----	-----

COTTAGE CORSAIR 2/4 - 1 - 1 - 1 - 20m²

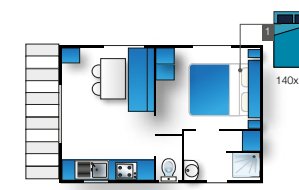

Ancienneté du locatif
2 ans



X 2

GAMME CONFORT

(TV + 1 accès WiFi + coffre-fort / TV + 1 WiFi access + safe security)

26/03	28/04	08/05	25/05	05/06	01/07	08/07	15/07	22/07	28/07	12/08	19/08	26/08	03/09	18/09	02/10
27/04	07/05	24/05	04/06	30/06	07/07	14/07	21/07	28/07	11/08	18/08	25/08	02/09	17/09	01/10	29/10
67€	93€	46€	102€	89€	125€	145€	160€	167€	176€	170€	147€	118€	82€	61€	58€

CHALET NEMO 4 - 2 - 1 - 1 - 23m²

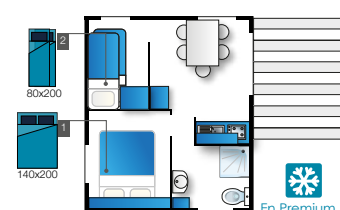

Ancienneté du locatif
5 ans



X 2

GAMME CONFORT

(TV + 1 accès WiFi + coffre-fort / TV + 1 WiFi access + safe security)

26/03	28/04	08/05	25/05	05/06	01/07	08/07	15/07	22/07	28/07	12/08	19/08	26/08	03/09	18/09	02/10
27/04	07/05	24/05	04/06	30/06	07/07	14/07	21/07	28/07	11/08	18/08	25/08	02/09	17/09	01/10	29/10
71€	96€	49€	104€	92€	135€	156€	171€	173€	186€	180€	154€	125€	84€	67€	64€

GAMME PREMIUM

(gamme confort + climatisation / Air conditioner)

86€	111€	64€	119€	107€	165€	186€	201€	203€	216€	210€	184€	155€	99€	82€	79€
-----	------	-----	------	------	------	------	------	------	------	------	------	------	-----	-----	-----

COTTAGE BLUE LAGON 2 - 2/4 - 1 - 1 - 1 - 23m²

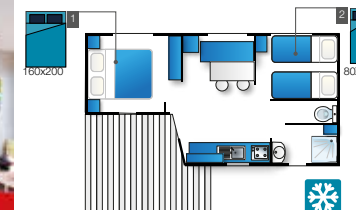

Ancienneté du locatif
10 ans



X 2

GAMME CONFORT

(TV + 1 accès WiFi + coffre-fort / TV + 1 WiFi access + safe security)

26/03	28/04	08/05	25/05	05/06	01/07	08/07	15/07	22/07	28/07	12/08	19/08	26/08	03/09	18/09	02/10
27/04	07/05	24/05	04/06	30/06	07/07	14/07	21/07	28/07	11/08	18/08	25/08	02/09	17/09	01/10	29/10
71€	96€	49€	104€	92€	135€	156€	171€	173€	186€	180€	154€	125€	84€	67€	64€

GAMME PREMIUM

(gamme confort + climatisation / Air conditioner)

86€	111€	64€	119€	107€	165€	186€	201€	203€	216€	210€	184€	155€	99€	82€	79€
-----	------	-----	------	------	------	------	------	------	------	------	------	------	-----	-----	-----



TV, WiFi et coffre-fort sont inclus dans tous nos locatifs.
TV, WiFi and strongbox are included in all our accomodation

INVENTAIRE TYPE

INVENTORY TYPE

- Assiettes plates / dinner plates
- Assiettes creuses / soup plates
- Assiettes à dessert / dessert plates
- Couteaux de table / table knives
- Cuillères / tablespoons
- Cuillères à café / teaspoons
- Fourchettes / forks
- Tasses à café / coffee cup
- Bols / Bowls
- Lot de casseroles / set of saucepans
- Plats / dishes
- Saladiers / salad bowls
- Verres / glasses
- Verres apéritifs / glasses aperitifs
- Pichet / pitcher
- Poêles / frying pans
- Cafetière / coffee maker
- Grille-pain / toaster
- Faitout / pot
- Couvert à salade / salad server
- Tire-bouchon / corkscrew
- Couteau office / paring knife
- Louche / ladle
- Écumoire / skimmer
- Spatule / spatula
- Grand couteau / large knife
- Passoire / colander
- Planche à découper / cutting board
- Dessous de plat / trivet
- Ouvre-boîte / opener
- Économe / peeler
- Égouttoire à légumes / vegetable drainer
- Essoreuse à salade / salad spinner
- Seau / bucket
- Ensemble WC / toilets set
- Balai brosse / brush broom
- Balai / broom
- Pelle à poussières / dust shovel
- Séchoire à linge / clotheshorse
- Couvertures et oreillers / covers and pillows
- Salon de jardin + chaises / garden furnitures + chairs
- TV

COTTAGE MÉDITERRANÉE - 4 personnes - 2 chambres - 1 salle de bain - 27m²

Ancienneté du locatif 1 à 2 ans

X 2

GAMME CONFORT (TV + 1 accès WiFi + coffre-fort / TV + 1 WiFi access + safe security)															
26/03	28/04	08/05	25/05	05/06	01/07	08/07	15/07	22/07	28/07	12/08	19/08	26/08	03/09	18/09	02/10
27/04	07/05	24/05	04/06	30/06	07/07	14/07	21/07	28/07	11/08	18/08	25/08	02/09	17/09	01/10	29/10
73€	100€	64€	109€	107€	145€	170€	181€	186€	199€	195€	164€	131€	90€	69€	66€
GAMME PREMIUM (gamme confort + climatisation / Air conditioner)															
88€	115€	79€	124€	122€	175€	200€	211€	216€	229€	225€	194€	161€	105€	84€	81€

CHALET MORÉA - 5 personnes - 2 chambres - 1 salle de bain - 28m²

Ancienneté du locatif 5 ans

X 2

GAMME CONFORT (TV + 1 accès WiFi + coffre-fort / TV + 1 WiFi access + safe security)															
26/03	28/04	08/05	25/05	05/06	01/07	08/07	15/07	22/07	28/07	12/08	19/08	26/08	03/09	18/09	02/10
27/04	07/05	24/05	04/06	30/06	07/07	14/07	21/07	28/07	11/08	18/08	25/08	02/09	17/09	01/10	29/10
75€	104€	67€	120€	100€	153€	179€	188€	194€	208€	202€	178€	136€	100€	71€	68€
GAMME PREMIUM (gamme confort + climatisation / Air conditioner)															
90€	119€	82€	135€	115€	183€	209€	218€	224€	238€	232€	208€	166€	115€	86€	83€

COTTAGE BLUE LAGON 3 - 6 personnes - 3 chambres - 1 salle de bain - 28m²

Ancienneté du locatif 5 ans

X 2

GAMME CONFORT (TV + 1 accès WiFi + coffre-fort / TV + 1 WiFi access + safe security)															
26/03	28/04	08/05	25/05	05/06	01/07	08/07	15/07	22/07	28/07	12/08	19/08	26/08	03/09	18/09	02/10
27/04	07/05	24/05	04/06	30/06	07/07	14/07	21/07	28/07	11/08	18/08	25/08	02/09	17/09	01/10	29/10
79€	109€	72€	135€	115€	174€	199€	210€	217€	233€	227€	203€	158€	118€	79€	76€
GAMME PREMIUM (gamme confort + climatisation / Air conditioner)															
94€	124€	87€	150€	130€	204€	229€	240€	247€	263€	257€	233€	188€	133€	94€	91€

CHALET SAMOA - 6 personnes - 3 chambres - 1 salle de bain - 32m²

Ancienneté du locatif 5 ans

X 2 (Chambres)

GAMME CONFORT (TV + 1 accès WiFi + coffre-fort / TV + 1 WiFi access + safe security)															
26/03	28/04	08/05	25/05	05/06	01/07	08/07	15/07	22/07	28/07	12/08	19/08	26/08	03/09	18/09	02/10
27/04	07/05	24/05	04/06	30/06	07/07	14/07	21/07	28/07	11/08	18/08	25/08	02/09	17/09	01/10	29/10
79€	109€	72€	135€	115€	174€	199€	210€	217€	233€	227€	203€	158€	118€	79€	76€
GAMME PREMIUM (gamme confort + climatisation / Air conditioner)															
94€	124€	87€	150€	130€	204€	229€	240€	247€	263€	257€	233€	188€	133€	94€	91€

COTTAGE RESORT TAILLAT - 4/6 - 2 - 2 - 32m² Design moderne confort maximal



GAMME VIP
(Confort premium + draps/serviettes de toilette* + lave-vaisselle + 2 accès WiFi + accès illimité au SPA* + nettoyage fin de séjour offert**)

26/03	28/04	08/05	25/05	05/06	01/07	08/07	15/07	22/07	28/07	12/08	19/08	26/08	03/09	18/09	02/10
27/04	07/05	24/05	04/06	30/06	07/07	14/07	21/07	28/07	11/08	18/08	25/08	02/09	17/09	01/10	29/10
130€	160€	130€	170€	155€	230€	254€	265€	262€	288€	282€	258€	213€	153€	140€	130€

** 7 nuits * 4 nuits minimum

CHALET SAMOA PMR & - 6 - 2 - 1 - 32m²



GAMME CONFORT
(TV + 1 accès WiFi + coffre-fort / TV + 1 WiFi access + safe security)

26/03	28/04	08/05	25/05	05/06	01/07	08/07	15/07	22/07	28/07	12/08	19/08	26/08	03/09	18/09	02/10
27/04	07/05	24/05	04/06	30/06	07/07	14/07	21/07	28/07	11/08	18/08	25/08	02/09	17/09	01/10	29/10
75€	104€	67€	120€	100€	153€	179€	188€	194€	208€	202€	178€	136€	100€	71€	68€

NOS EMPLACEMENTS: TENTES*

OUR PITCHES: TENTS*

* Caravanes et camping-car interdits
* Caravans and motor homes prohibited

PRIX PAR NUIT EN EUROS DE 14H À 12H	28/04 au 09/05	10/05 au 24/05	25/05 au 11/06	12/06 au 30/06	01/07 au 15/07	16/07 au 23/07	24/07 au 20/08	21/08 au 27/08	28/08 au 03/09	04/09 au 01/10
* forfait une tente + 2 pers. + voiture	30€	36€	34€	40€	59€	68€	71€	59€	48€	38€
Bébé (-3ans)	gratuit									
Enfant (3 à 7 ans)	gratuit				7€	7€	7€	7€	7€	gratuit
Pers. sup 7 ans et +	7€	7€	7€	7€	9€	9€	9€	9€	9€	7€
Location de réfrigérateur	8€	8€	8€	8€	8€	8€	8€	8€	8€	8€
Animal	6€	6€	6€	6€	6€	6€	6€	6€	6€	6€
Véhicule supp. / tente sup. /reporque	8€	8€	8€	8€	8€	8€	8€	8€	8€	8€
Taxe de séjour / jour / pers. + 18 ans	0,66€	0,66€	0,66€	0,66€	0,66€	0,66€	0,66€	0,66€	0,66€	0,66€

OFFRE SPÉCIALE SPECIAL OFFER

-15%

Sur une durée minimale de 10 nuits (réduction s'applique sur les forfaits uniquement) For a minimum stay of 10 nights (discount applies to packages only)
Du 26/03/2017 au 07/07/2017 et du 03/09/2017 au 29/10/2017
From 26/03/2017 to 07/07/2017 and from 03/09/2017 to 29/10/2017

Tous nos emplacements sont grand confort (eau, électricité et accès WiFi)
All our pitches are very comfortable (water, electricity and WiFi access)

OPTIONS

Accès au SPA	
Séance d'une heure	20€/personne
pass 5 séances	80€
Jeton de machine à laver	
	5€

Location / Rent barbecue	
1 jour	11€
2 jours	18€
7 jours	38€
14 jours	61€

Location Rent paddle	
1 jour	30€
7 jours	120€
Location / Rent Kit bébé	
20€/semaine	

Kit serviettes de toilette	Kits draps (pour un lit)
10€	17€
Location / Rent VTT	
1 jour	10€
7 jours	35€

CONTRAT DE RÉSERVATION 2017

BOOKING FORM 2017



Camping Cap Taillat - 1911 Route de l'Escalet 83350 Ramatuelle France
 Tél. : 33 (0)4 94 79 22 53 – Fax: 33 (0)4 94 79 12 05 - Web: <http://www.camping-captailat.com>
 SARL LE ST TROP au capital de 520.000 Euros euros, dont le siège social est:
 Camping Cap Taillat, Route de l'Escalet 83 350 RAMATUELLE - N° SIRET: 53151906400012 RCS: Frejus B 531 519 064 - APE: 5530Z

NOMS ET CONTACT / NAME AND CONTACT DETAILS

Nom / Family name Prénom / First name
 Adresse / Adresse
 Code postal / Postcode Ville / City
 Pays / Country Nationalité / Nationality
 N° de tél. / Tel no Email / Email @

Ce contrat est nominatif et ne peut être cédé.

Liste des participants / CUSTOMERS' LIST

Nom / Name	Prénom / First name	Date de naissance / Date of birth	Âge / Age
1.			
2.			
3.			
4.			
5.			
6.			

LOCATION HÉBERGEMENT / ACCOMMODATION RENTAL

GAMME CONFORT

- Cottage BLUE LAGON 1 - 1 ch. 2/3 pers. Cottage MÉDITERRANÉE - 2 ch.
 Cottage CORSAIR - 1 ch. 2/4 pers. Cottage BLUE LAGON 3 - 3 ch. 6 pers.
 Chalet NEMO - 2 ch. 4 pers. Chalet MORÉA - 2ch. 5 pers.
 Cottage BLUE LAGON 2 - 2 ch. 4 pers.

GAMME PREMIUM

- Cottage BLUE LAGON 1 - 1 ch. 2/3 pers. Cottage BLUE LAGON 3 - 3 ch. 6 pers.
 Chalet NEMO - 2 ch. 4 pers. Chalet MORÉA - 2ch. 5 pers.
 Cottage BLUE LAGON 2 - 2 ch. 4 pers. Chalet SAMOA - 3CH. 6 PERS.
 Cottage MÉDITERRANÉE - 2 ch. 4 pers.

GAMME VIP

- Cottage RESORT TAILLAT - 2ch. 4/6 pers.

GAMME PMR

- Chalet SAMOA - 2ch. 6 pers.
 Pers. supp. x ...

Arrivée le / Arrival après 16 h / after 4 pm Départ le / Departure avant 10 h / before 10 am

EMPLACEMENTS / CAMPING PLACE

- Forfait 1 tente, 1 voiture, 2 personnes, eau, électricité et 1 accès WiFi / Package 1 tent, 1 car, 2 people, water and electricity Séjour du / Stay from / /20 à / to / /20
 Personne supplémentaire (Voir Tarifs) / Additional persons (See Price) Tentes supplémentaire / Additional tent X 8€ / jour (day)

Arrivée le / Arrival après 14 h / after 2 pm Départ le / Departure avant 12 h / before 12 am

OPTIONS / OPTIONS

- 1 Accès SPA 1 heure (20€/personne) / Acces SPA 1hour (€20/person) Nombre / Number 1 Pass semaine -5 accès (80€/pers) / 1 SPA PASS - 5 acces (€80/person) Nombre / Number
 2^{ème} véhicule ou remorque / 2nd Car or Trailer X (8/jour/day) Location Barbecue* (38€ la semaine) / Rent Barbecue* (€38 week)
 Kit Serviette toilette / Towel toilet Kit X (10€/ séjour (stay)) Kit draps / Set of sheets X (17€/séjour(stay))
 Location / rent VTT* NB (Voir tarif / See Price) Location / Rent Paddle* X (30€/jour/Day)
 Kit bébé / baby Kit* (20€/séjour(stay)) Nettoyage Final / Household (60€/séjour(stay)) Animal (6€/jour/day)

* Quantité limité, sous réserve de disponibilité / Limited quantity, subject to availability

Je souscris à l'assurance annulation (3€ par nuits) / I agree with the cancellation insurance (€ 3 per night) Oui / Yes Non / No

Frais de dossier / Administrative Cost: 20€

MONTANT TOTAL DU SEJOUR / TOTAL AMOUNT OF STAY: Nombre de nuits / Number Nights X Prix (Price) / Nuit (Night) = € ACOMPTE / DEPOSIT TO 50% €

Je déclare avoir pris connaissance des conditions générales de vente en page 2. La signature vaut (3 derniers chiffres au dos) acceptation de celles-ci. Je m'engage donc à régler le solde 30 jours* avant la date d'arrivée.*

I have read the conditions the General sales page 2. The signature is acceptance thereof. I therefore agree to settle* the balance 30 days before arrival.*

MODALITÉS DE PAIEMENT

- Chèque Virement bancaire / Bank Transfer IBAN CAPTILLAT FR76 1560 7000 7860 5216 1086 522 CCBPFRPNCE
 Carte bancaire / Credit Card (visa / mastercard) N° [] Cryptogramme []
 Date d'expiration / date of expiry / Nom du porteur

J'ai pris connaissance des conditions de vente et les accepte toutes. / The tenant declares that he is aware of and fully accepts the obligations of the contract, the booking conditions, the rules and the price of the campsite.

À le

«Bon pour accord» et signature

Signature de la direction du camping

GENERAL TERMS CONDITIONS

HOW TO BOOK YOUR RENTAL OR YOUR LOCATION?



Go to our website and let yourself be guided to make your reservation online and use our secure online payment.
www.camping-captailat.com



Contact us by e-mail: info@camping-captailat.com



By phone: **04 94 79 22 53**



By post: **1911 route de l'Escalet - 83350 RAMATUELLE**

So as to be able to benefit from the proposed services, we would ask you to read the general booking terms set out below attentively. These terms govern the sales of stays, and are valid at the moment the booking is made. Reserving a stay implies full compliance with our general booking terms.

DATES AND OPENING TIMES:

The Cap Taillat campsite is open from 26 March 2017 to 29th October 2017. The reception desk is open every day: - Low season (April - June and September - October) from 9.00 a.m. to 12.00 noon, and from 3.00 p.m. to 6.00 p.m. - Peak season (July & August) from 8.30 a.m. to 12.30 noon, and from 3.00 p.m. to 7.30 p.m. Telephone lines are open throughout the year for any information, from Mondays to Saturdays, between 9.00 a.m. and 12.00 noon, and between 2.00 p.m. and 7.00 p.m.

BOOKING TERMS:

The booking takes effect only with the agreement of the campsite, after reception of the deposit and the reservation form duly completed and signed, or after acceptance of the general terms of sale for on-line bookings. The reservation of a camping pitch or of rented accommodation is made on a strictly personal basis. In no case is it authorised to sublet or to hand over one's reservation to another party without first obtaining permission from the management. Under-age children must be accompanied by their parents or legal guardians.

The camping pitch: The basic rate includes the pitch for the tent, the caravan or the camper for 1 or 2 people, electricity and access to the reception infrastructures. Additional costs (extra person, child or adult, or additional vehicle) are not included in the fixed rate, and will be added to the aforesaid set rate. The time of arrival is fixed at 2.00 p.m. at the earliest, and the time of departure will be no later than 12.00 noon. It may be possible to stay longer on the site according to availability.

Rentals: The rented accommodation includes a fitted kitchen, shower-room and bedroom(s). N.B. It is important to note that sheets, tea-towels, dusters, cloths (for household tasks), household cleaning products and towels are not provided. • The rates for rentals include the people (depending on the size of the accommodation), water, gas, electricity, a vehicle and access to the facilities on the campsite. During the peak season (July & August), only bookings for a minimum of 7 days are accepted. The campsite reserves the right to refuse access to groups or families who arrive with more people than the rented accommodation can cater for, or to increase the cost of the stay.

RATES AND TOURIST TAX:

The prices indicated are valid for the 2017 season. They correspond to a rented accommodation for one night, in euros, all taxes included, barring the tourist tax, which is €0.66 per day and per person of and over 18 years of age. This tax is collected by the municipality, and is invoiced with your accommodation. You will be required to pay this tax on your arrival at the campsite.

TERMS OF PAYMENT:

You will be required to pay a 50% deposit when you make your booking, and the balance is to be paid 30 days before your arrival. Should the reservation be made less than 30 days before your arrival, then the total amount of the stay must be paid when booking, and BY BANKER'S CARD ONLY. Should the balance of the stay not reach us within the 30 days before the arrival date, the stay will

be considered as cancelled (see terms of refund of sums paid in the paragraph "Cancellation by client").

HOW TO RESERVE:

- By Internet: Log onto www.camping-captailat.com and book your stay on line 24h/24, (security of payment) in less than 10 minutes. Payment can be made by banker's card only (visa, debit card, Mastercard). You will be required to pay a 50% deposit of the total amount of your stay, and, with your agreement, the balance of your stay will be directly debited (on the same banker's card) 30 days before your arrival. By telephone: Our sales team will advise you according to what you are looking for, and your budget, and will register your reservation. You will be required to pay a 50% deposit of the total amount of your stay when you make your booking. By ordinary mail: Send us your reservation form, together with a 50% deposit of the total amount of the stay. Whichever booking formula you choose, you will be asked to pay a deposit in order to validate your booking. Upon reception of your booking form and deposit, we will then confirm your reservation. The balance of your stay is to be paid 30 days before your arrival. We reserve the right to choose the allocated places. It is imperative that you complete the booking form correctly. Any incomplete or illegible booking form risks holding up the processing of the file.

CANCELLATIONS AND CHANGES:

1. With no message from you to notify that the date of arrival has been put back: the accommodation could once again be available for sale 24 hours after the date of arrival indicated on the contract; you will therefore not be able to benefit from your reservation, and will lose the sums paid (see the terms of payability of sums in the paragraph "Cancellation by the client"). 2. Services not used: Any stay in rented accommodation which is cut into or shortened (late arrival, early departure) by the client will not be refundable. Cancellation by the Cap Taillat campsite: In the event of a cancellation by the Cap Taillat campsite, except in the case of 'force majeure', the total amount of the stay will be refunded. However, this cancellation will not give rise to a payment of any whatsoever compensation. 3. Cancellation by the client: All cancellations of a reservation must be made in writing (registered letter with acknowledgement of receipt). The sums paid, whether deposits or the total amount of the stay, can be covered by the cancellation guarantee explained below. The refund of the sums paid will be carried out, with a deduction of the sums specified below: A) If a cancellation insurance has been taken out: We guarantee the refund of the sums paid to the campsite, barring administrative costs related to the cancellation (€20) up to the day before your arrival, on the condition that the cancellation is for the following serious motives: -the person who has booked, or his/her spouse, or one of his/her children is seriously ill, -the person who has booked, or his/her spouse, or one of his/her children has had a serious accident, -the person who has booked, or his/her spouse, or one of his/her descendants has died, the person who has booked, or his/her spouse has been made redundant. B) If no cancellation insurance has been taken out: If the cancellation is made: -More than 30 days before the date the stay is due to commence, the deposit paid will be kept by the campsite. -Less than 30 days before the date the stay is due to commence: -If the total amount of the stay has been paid: the campsite will keep 100% of this amount -If only a deposit has been paid: the balance which remains becomes payable immediately. The client acknowledges that he is expressly responsible for settling the said debt to the campsite..

YOUR STAY:

1. Rented accommodation: The rentals will be at your disposal as from 4.00 p.m. the day of your arrival. A security of €300 will be requested on the client's arrival, before he/she is handed the keys. This security will be given back to the client, after a complete inspection of the premises (INVENTORY) the day of his/her departure, or at the latest after a delay of 8 days maximum. The management reserves the right to keep all or a part of the security in the event of a non-respect of the hygiene and/or of the rented material. If the departure of the client is to take place outside reception opening times, the rented accommodation will be inspected later, and the security cheque will be returned by post within a maximum of 8 days. 2. During your stay: It is for the holiday-maker to make his/her own arrangements where insurance coverage is concerned; the village accepts no responsibility in the event of theft, fire, bad weather etc., or for any incident concerning the holiday-maker's TPL (Third Party Liability). Each titular resident of a rental is responsible for any disturbance caused by the people sharing the said rental, or by any visitors received in this rental. 3. Departure: Rentals: On the day of departure indicated on your contract, the rented accommodation must be vacated before 10.00 a.m. The accommodation must be left in a perfect state of cleanliness. An inventory will be carried out, and the cost of repairing any damage or breakage will be borne by the client. Likewise, the client will bear the cost of getting the accommodation back into its original state, should this be necessary. The security charge will be given back at the end of the stay (or will be posted to you no later than 8 days after your departure), after deduction of any sum intended to cover the costs in the event of any damage being noted during the inventory at the end of the stay. The holding back of the security does not exclude the right to request further compensation should the costs exceed the sum of the security. Should the rental not have been cleaned before your departure, you will be requested to pay a fixed price of €55 per bungalow for cleaning services. For any delayed departure, an additional day could be invoiced to you (nightly rates in force).

ANIMALS:

Pets are accepted at a fixed price (refer to "Rates Terms"). Animals must at all times be supervised, and kept on leads by their owners during the stay at the campsite. Any non-respect of hygiene or of safety caused by the animal could be punished by the eviction from the campsite of its owners, with no refund whatsoever of the sums paid. The vaccination papers for dogs and cats must be up to date and valid. Animals are strictly forbidden around the swimming-pools, in food stores and inside the campsite's buildings.

LITIGATION:

In the event of litigation, competence is delegated to the courts based in the jurisdiction of the campsite. To resolve any dispute, please first contact customer service at the office. If your concern is not resolved, you have the option to request mediation via Medicycs consumer services, provided that you do so within one year of the date you submitted a written copy of your complain to us, with return receipt and signature confirmation. Medicycs, 73 boulevard de Clichy, 75009 PARIS - 01.49.70.15.93 - contact@medicycs.fr

